

▼ ZUTP1500SE-H



- Solenoid-operated valve with 6 m pendant for remote control of valve and one-man operation
- Easily accessible manual override valve to release pressure if power is lost
- Safety relief valve limits output pressure
- Two-stage pump design provides high flow at low pressure for fast system fills and controlled flow at high pressure for accurate operation
- 1,25 kW heavy-duty universal motor provides the best performance-to-weight ratio
- Replaceable 10 micron in-line high-pressure filter helps maintain oil cleanliness for optimum performance
- Panel-mounted 153 mm pressure gauge, with polycarbonate cover, is set into the protective metal shroud for improved visibility.

## ZUTP Series

Reservoir Capacity:

**4,0 litres**

Flow at Rated Pressure:

**0,33 l/min**

Motor Size:

**1,25 kW**

Maximum Operating Pressure:

**1500 bar**



### ZUTP-Tensioning Pumps

ZUTP-pumps achieve high-pressure without the need for an intensifier.

This allows for low maintenance, resulting in less cost for the end-user.

### ZUTP-S with Solenoid Valve

The ZUTP1500S with pendant-operated solenoid valve is ideal for multiple bolt tensioning applications as it allows for single-person operation. The operator can pressurize and depressurize the tensioner directly from the pendant.

OIL FLOW VERSUS PRESSURE

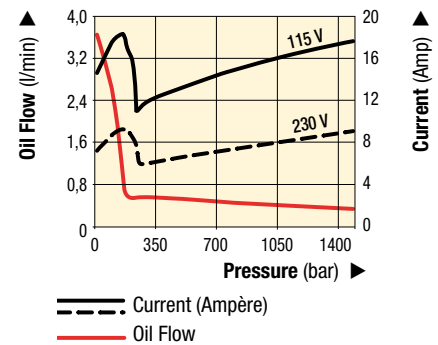

### 1500 BAR HIGH-PRESSURE PUMP

| Useable Oil Capacity (litres) | Valve Type | Model Number <sup>1)</sup>    | Pressure Rating (bar) | Output Flow Rate (l/min) |          | 1,25 kW Motor <sup>5)</sup> (VAC, 1-ph, 50 Hz) | Weight (kg) |
|-------------------------------|------------|-------------------------------|-----------------------|--------------------------|----------|--|-------------|
|                               |            |                               |                       | 0 bar                    | 1500 bar |  |             |
| 4,0                           | Solenoid   | ZUTP1500SB                    | 1500                  | 3,80                     | 0,33     | 115  | 29,5        |
|                               |            | ZUTP1500SE <sup>2)</sup>      |                       |                          |          | 230 <sup>2)</sup>                              |             |
|                               |            | ZUTP1500SI <sup>3)</sup>      |                       |                          |          | 230 <sup>3)</sup>                              |             |
| 4,0                           | Solenoid   | ZUTP1500SB-H <sup>4)</sup>    | 1500                  | 3,80                     | 0,33     | 115  | 34,0        |
|                               |            | ZUTP1500SE-H <sup>2) 4)</sup> |                       |                          |          | 230 <sup>2)</sup>                              |             |
|                               |            | ZUTP1500SI-H <sup>3) 4)</sup> |                       |                          |          | 230 <sup>3)</sup>                              |             |
| 4,0                           | Jog        | ZUTP1500B                     | 1500                  | 3,80                     | 0,33     | 115  | 29,5        |
|                               |            | ZUTP1500E <sup>2)</sup>       |                       |                          |          | 230 <sup>2)</sup>                              |             |
|                               |            | ZUTP1500I <sup>3)</sup>       |                       |                          |          | 230 <sup>3)</sup>                              |             |

<sup>1)</sup> All models meet CE safety requirements and all TÜV requirements.

<sup>2)</sup> European plug and CE EMC directive compliant.

<sup>3)</sup> With NEMA 6-15 plug. <sup>4)</sup> H = with heat exchanger. <sup>5)</sup> Sound level 89 dBA.

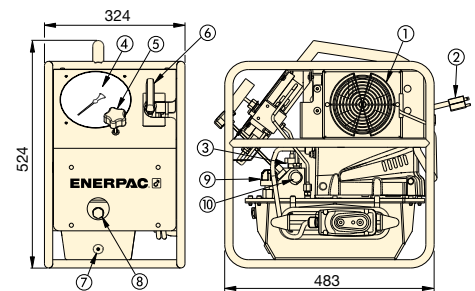

- ① Heat Exchanger (optional)
- ② Power Cord
- ③ Solenoid Dump Valve
- ④ Pressure Gauge
- ⑤ User Adjustable Relief Valve
- ⑥ Manual Release Valve
- ⑦ Oil Drain
- ⑧ Oil Level Sight Glass
- ⑨ Breather
- ⑩ Outlet Port with CEJN Coupler (116 Series)